







ÁREAS DE PAVTO A DEMOLIR
 PAVTO DE CONCRETO SIMPLES = 225,23m²
 PAVTO DE LAJOTAS SEXTAVADAS = 276,64m²
 Atotal de pavimento a ser demolido = 501,87 m²

LEGENDA

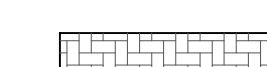
-  PISO DE CONCRETO EXISTENTE A DEMOLIR
-  PISO DE TERRENO NATURAL
-  PISO DE LAJOTAS SEXTAVADAS A DEMOLIR
-  PISO DE PAVER DE CONCRETO EXISTENTE A DEMOLIR
-  PISO DE PARALELEPIPEDO EXISTENTE A DEMOLIR
-  SUPORTE PLACA SINALIZAÇÃO
-  POSTE DE CONCRETO POSIÇÃO CERTA
-  POSTE DE CONCRETO POSIÇÃO EXISTENTE

- Obs.: 1) Nivelar todos os meios fios com h=15,0cm do pavto.
 2) Substituir os meios fios de materiais diferente e os quebrados.
 3) Realianhar testadas dos Lotes.
 4) Realianhar os Postes.

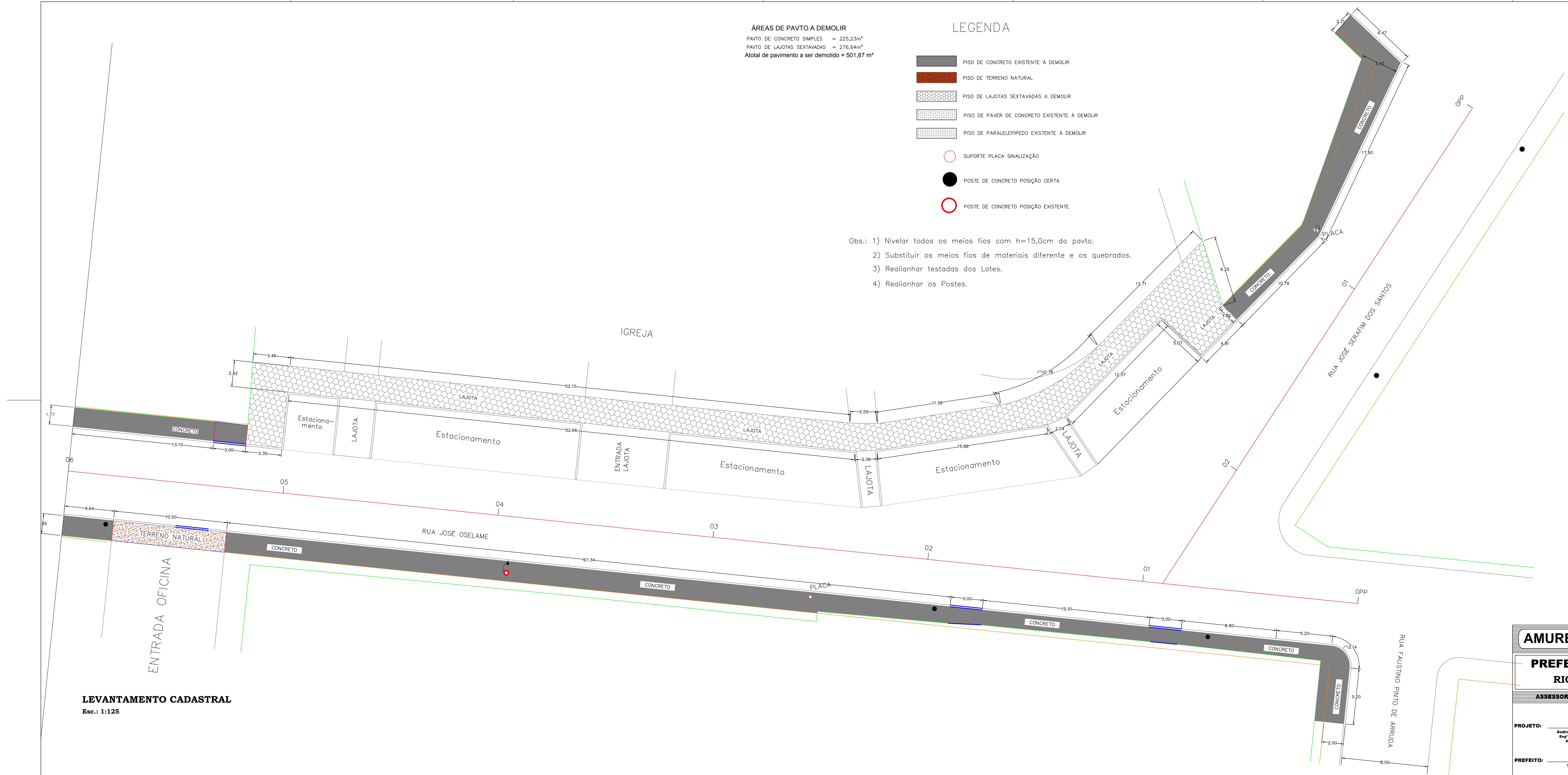

LEVANTAMENTO CADASTRAL
 Esc.: 1:125

AMURES 		ASSOCIAÇÃO DE MUNICÍPIOS DA REGIÃO SERRANA
PREFEITURA MUNICIPAL		02
RIO RUFINO - S.C.		
ASSESSORIA TÉCNICA	OBRA:	
PROJETO: Asdrúbal Guedes S.P.Filho. Eng.º Civil - CREA 14.081-S. ART. N. 6194709-9	LEVANTAMENTO PAVTO DE PASSEIOS EXISTENTE (Á DEMOLIR). Rua: JOSÉ OSELAME - TRECHO 01 (OPP á 06) Area=501,87m ²	
PREFEITO: Thiago Costa.		
DESENHO: Eng. Asdrúbal Guedes Filho	TOPOGRAFIA: Tec. Ag. Venício P. Bernardo	Escala: 1:500
		DATA: Maio/2017